

INNOVATION.
PRECISION.
AUTOMATION.



Aerospace / Medical Parts

SAT SERIES

Tilting EDM Rotary Tables Fully Submersible, Multi-Axis Machining

SAT cantilever type tilting rotary tables are designed specifically for compact multi-sided EDM machining. Fully sealed, air purges, and impervious to EDM debris, oil or water; SAT rotary tables are perfect for small EDM work spaces. The internal structure is isolated from the electric current and current collecting brushes help to effectively distribute electricity charge. Matsumoto SAT tables are constructed of stainless steel for full submersion under water or oil. Both models are ideal for sinker and/or hole-popper EDM applications.

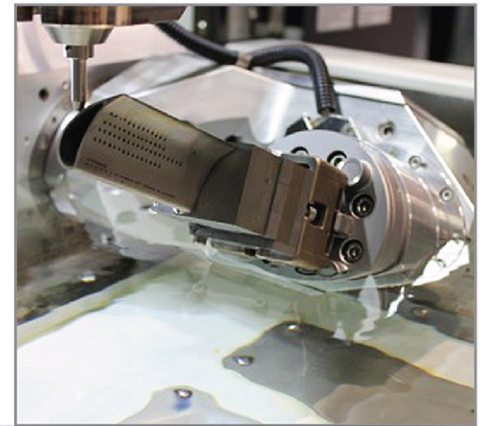

- ▶ Entirely sealed & air purged; IP68 class
- ▶ Stainless steel body and faceplate
- ▶ Multi-axis, simultaneous 'turn & burn' capable
- ▶ Compatible with System 3R & Erowa

SPECIFICATIONS	SATii100	SATii161
Table Diameter mm (in)	105 (4.13)	160 (6.30)
Table Height @ 0° mm (in)	160 (6.30)	182 (7.16)
Center height @ 90° mm (in)	160 (6.30)	257 (10.12)
Load Capacity kg (lb)	15 (33)	50 (110)
Net Weight kg (lb)	60 (132)	280 (617)

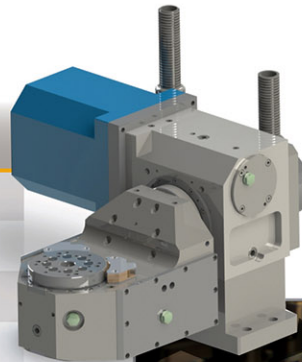

	Rotary		Tilt	
Motor Type	400W	800W	700W	1.8KW
Gear Ratio	1/60	1/60	1/90	1/90
Maximum Speed (RPM)	8.3	5.5	11.1	5.5
Accuracy (arc sec)	±10	±10	±10	±10
Repeatability (arc sec)	±2	±3	±2	±3

*Other servo motors available

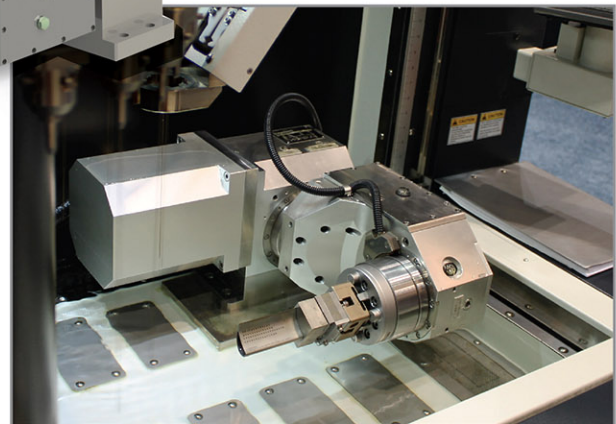

CUSTOM DESIGN ROTARY TABLES | EDM | GRINDING | LASER PROCESSING | MICRO-MACHINING | MILLING

FOLLOW US:

MMK Matsumoto Corp.

16 East Piper Lane | Suite 129 | Prospect Heights, IL 60070-1799 | (888) 665-1118 | info@MMKMatsumoto.com | www.MMKMatsumoto.com
Corporate Head Office: Kanazawa Japan | European Office: Lyon France



SAT SERIES

Tilting EDM Rotary Tables
Fully Submersible, Multi-Axis Machining

PRODUCT DRAWINGS

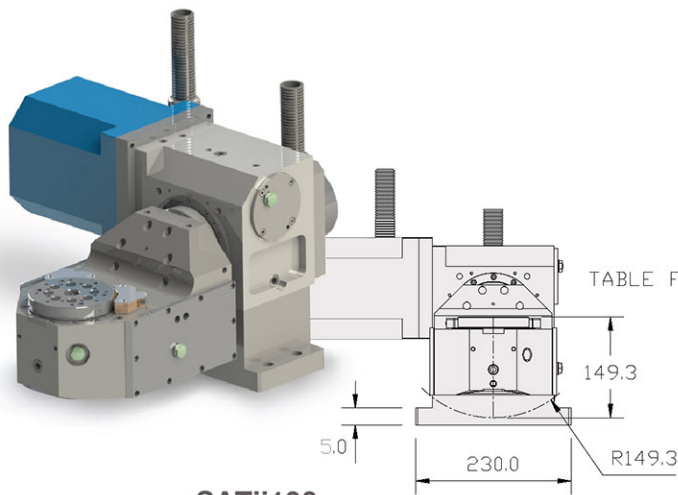

SATii100

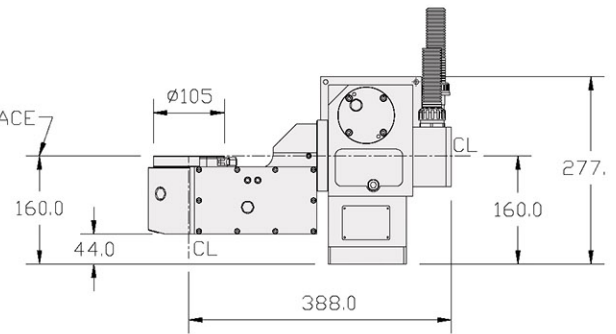
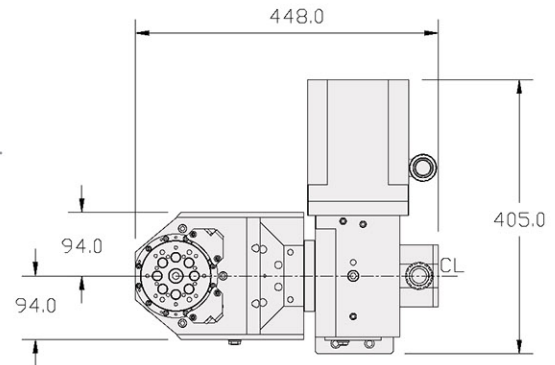

SATii161

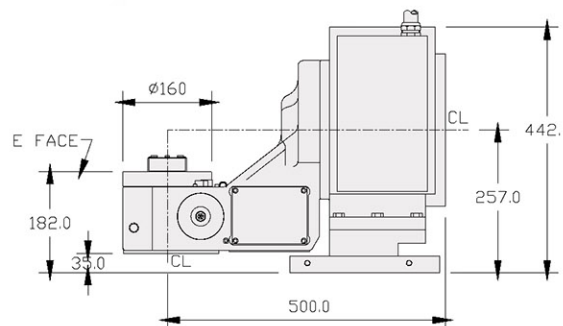
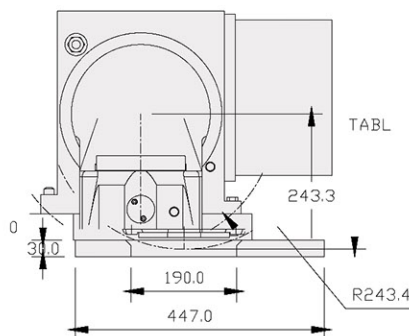
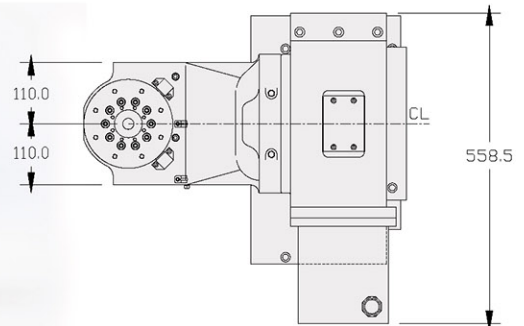
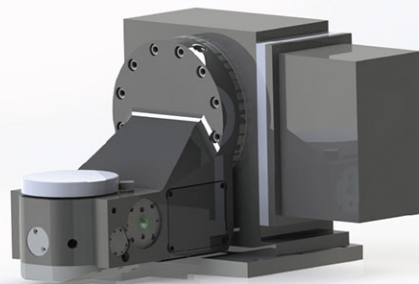

Optional Accessories

- ▶ EDM Chuck
- ▶ Collect System
- ▶ Tailstock
- ▶ Multi-Port Rotary Joint
- ▶ Independent CNC Controller