

INNOVATION.
PRECISION.
REPEATABILITY.



Aerospace / Energy / Medical

KEAT/KWAT SERIES

A/B-Axis For Wire EDM Fully Submersible, Tilting Tables

KEAT/KWAT trunnion style tilting tables are designed specifically for EDM Machining. Fully sealed, air purged, and impervious to EDM oil (KEAT), EDM water (KWAT) and debris; MMK tables are not only perfect for EDM operations, but are also capable of holding large, heavy workpieces. The internal structure of the table is isolated from the electricity and current-collecting brushes helping to protect the unit. KEAT/KWAT series A/B-axis tables are designed for full or partial submersion and typically used in die sinker and hole-popper applications.

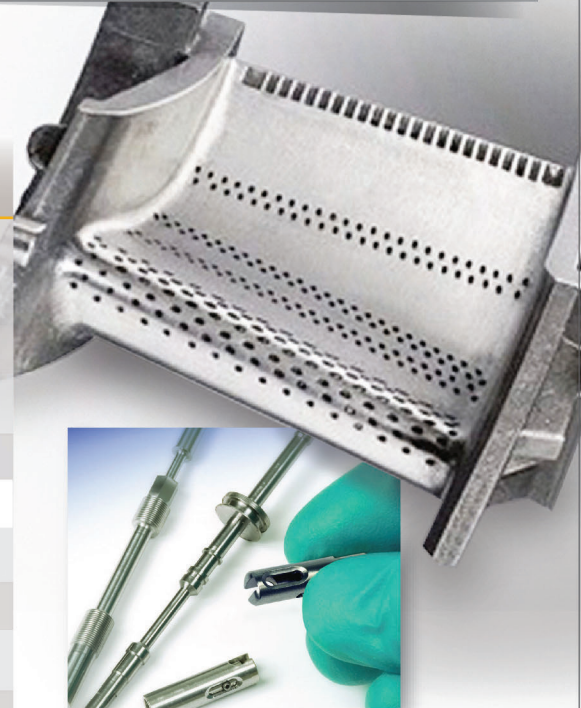
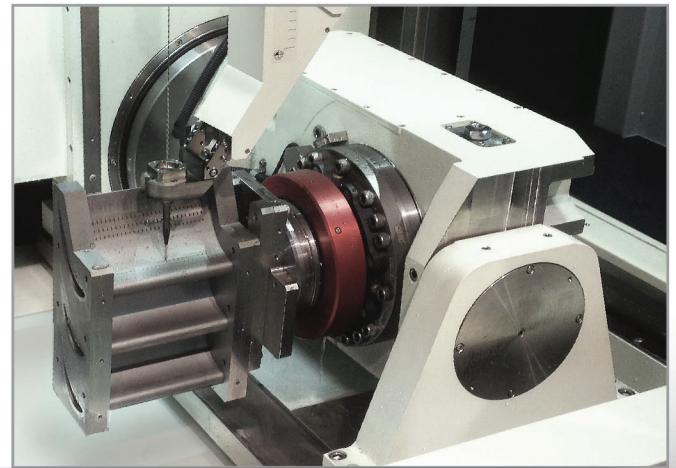

SPECIFICATIONS	KEATii150		KWAT250		MDEAT630	
	Rotary	Tilt	Rotary	Tilt	Rotary	Tilt
Table Dia. mm	105		254		1000	
Table Height @ 90° mm	232		579		1150	
Center Height @ 90° mm	140		245		605	
Load Capacity, kg (lb)	45 (99)		150 (330)		500 (1102)	
Net Weight kg (lb)	210 (463)		650 (1433)		2600 (5732)	
Gear Ratio	1/60	1/360	1/90	1/150	1/360	1/360
Maximum Speed (RPM)	5	3	6	4	5.5	5.5
Indexing Accuracy (arc sec)	14	20	14	60	12	60
Repeatability (arc sec)	±2	±2	±2	±2	±2	±3

Subject to technical changes, or to development of our products or manufacturing processes without advanced notice.

CUSTOM DESIGN ROTARY TABLES | EDM | GRINDING | LASER PROCESSING | MICRO-MACHINING | MILLING

FOLLOW US:

MMK Matsumoto Corp.

16 East Piper Lane | Suite 129 | Prospect Heights, IL 60070-1799 | (888) 665-1118 | info@MMKMatsumoto.com | www.MMKMatsumoto.com
Corporate Head Office: Kanazawa Japan | European Office: Lyon France



KEAT/KWAT SERIES

A/B-Axis For Wire EDM
Fully Submersible, Tilting Tables



EXEMPLARY PRODUCT DRAWINGS

MDWAT250

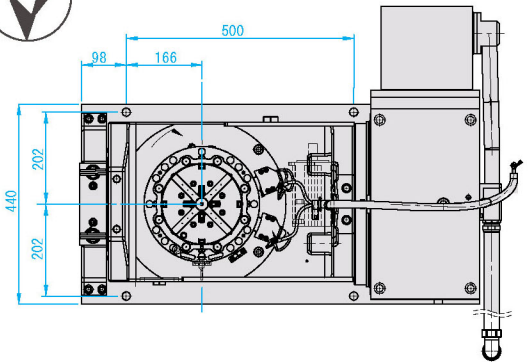
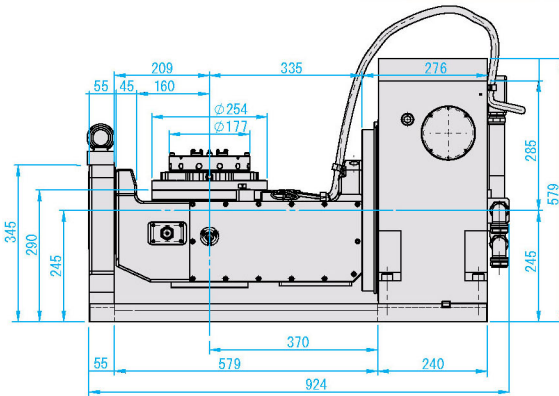
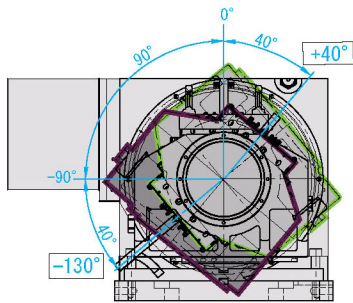

KEATii150

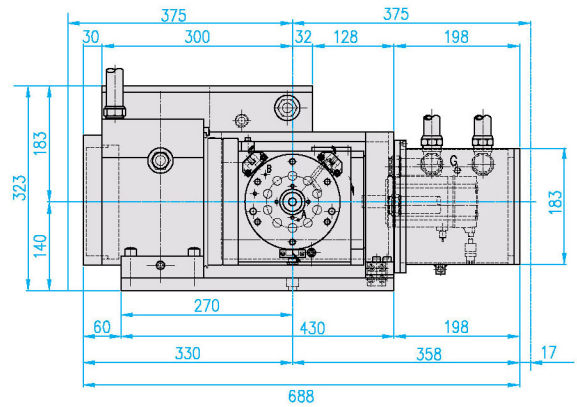
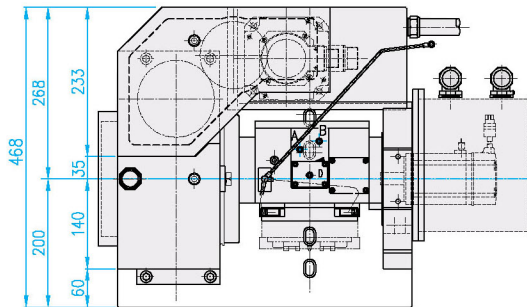

MDEAT630

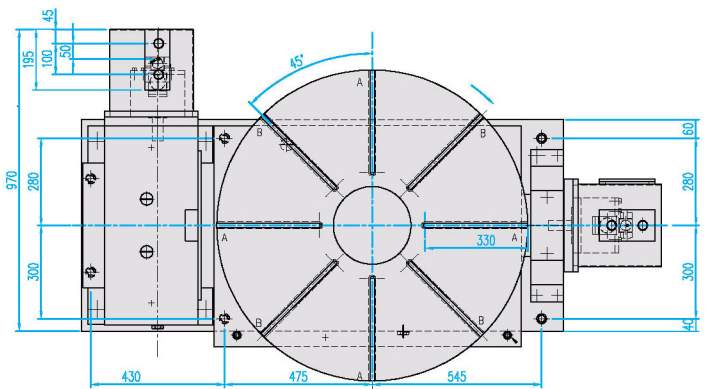
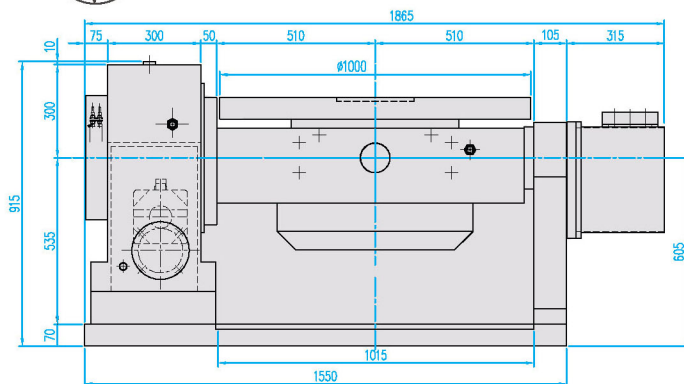

KEAT/KWAT SERIES

**A/-Axis For Wire EDM
Fully Submersible, Tilting Tables**

TYPICAL WORKPIECES

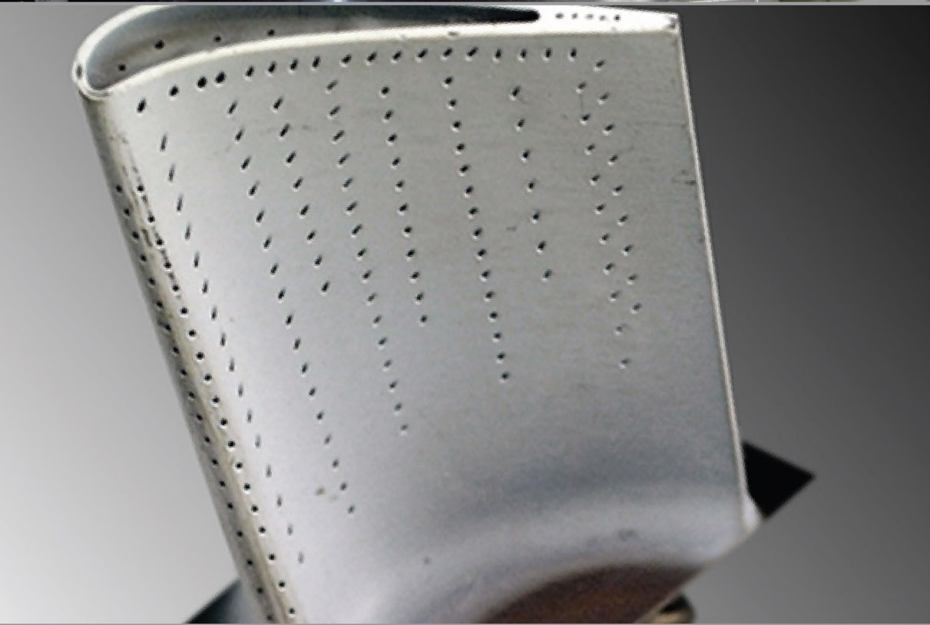
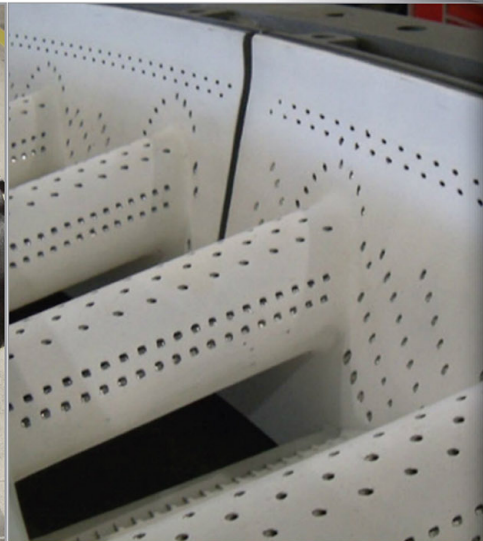
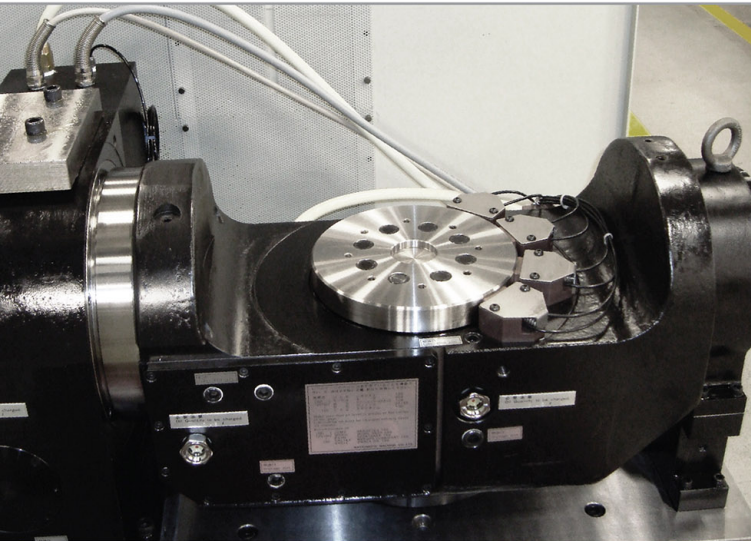

Optional Accessories

- ▶ EDM Chuck
- ▶ Collect System
- ▶ Tailstock
- ▶ Multi-Port Rotary Joint
- ▶ Independent CNC Controller